

Development update

Construction in the
neighborhood

GO Layover

- Long term plan is to move the entrance to the east, but no timeline provided.
- Complaints regarding noise and traffic delays can be directed to Transport Canada



Projects under
construction or
approved

Station Park

- Buildings on Wellington under construction



741 King Street W

- 18 storey mixed-use building
- 228 residential units
- Parking access from King and Walter streets

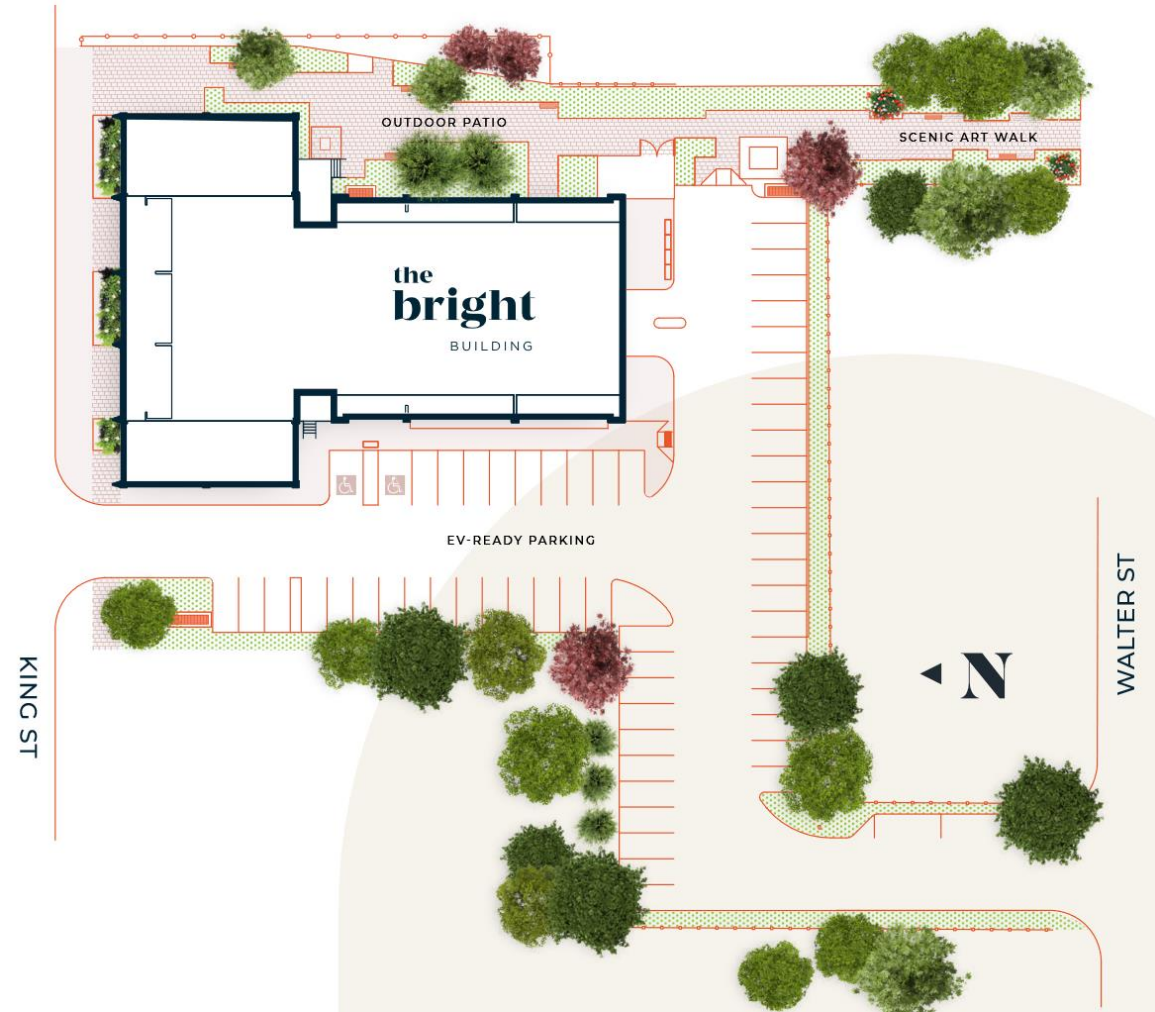

St Mark's Lutheran

- Groundbreaking ceremony September 2021



660
Belmont



New projects

Park and Victoria

- 3 towers, max 38 stories
- Rejected by council
- Developer has appealed to OLT



Getting involved

Engage Kitchener



Pop up sessions

- Mar. 18, 2023 – Kitchener Market indoors from 9 a.m. to 2 p.m.
- Mar. 18, 2023 – Carl Zehr Square from 4 to 6 p.m. (UPDATED TIME)

DTK Map

What are your favourite places in downtown Kitchener?

What ideas do you have for the future of downtown Kitchener?

Share your comments and photos on our interactive map!

Instructions:

1. Zoom into to the place in DTK you want to pin.
2. Click the plus sign (+) to choose one of two pins: **favourite places** or **future ideas**.
3. Drag and drop the pin to the right place.
4. Add your comments and photos to that pin.
5. Click 'Submit'.
6. Add as many pins as you like! It's also ok for a location to have multiple pins.

Map closes: March 31, 2023

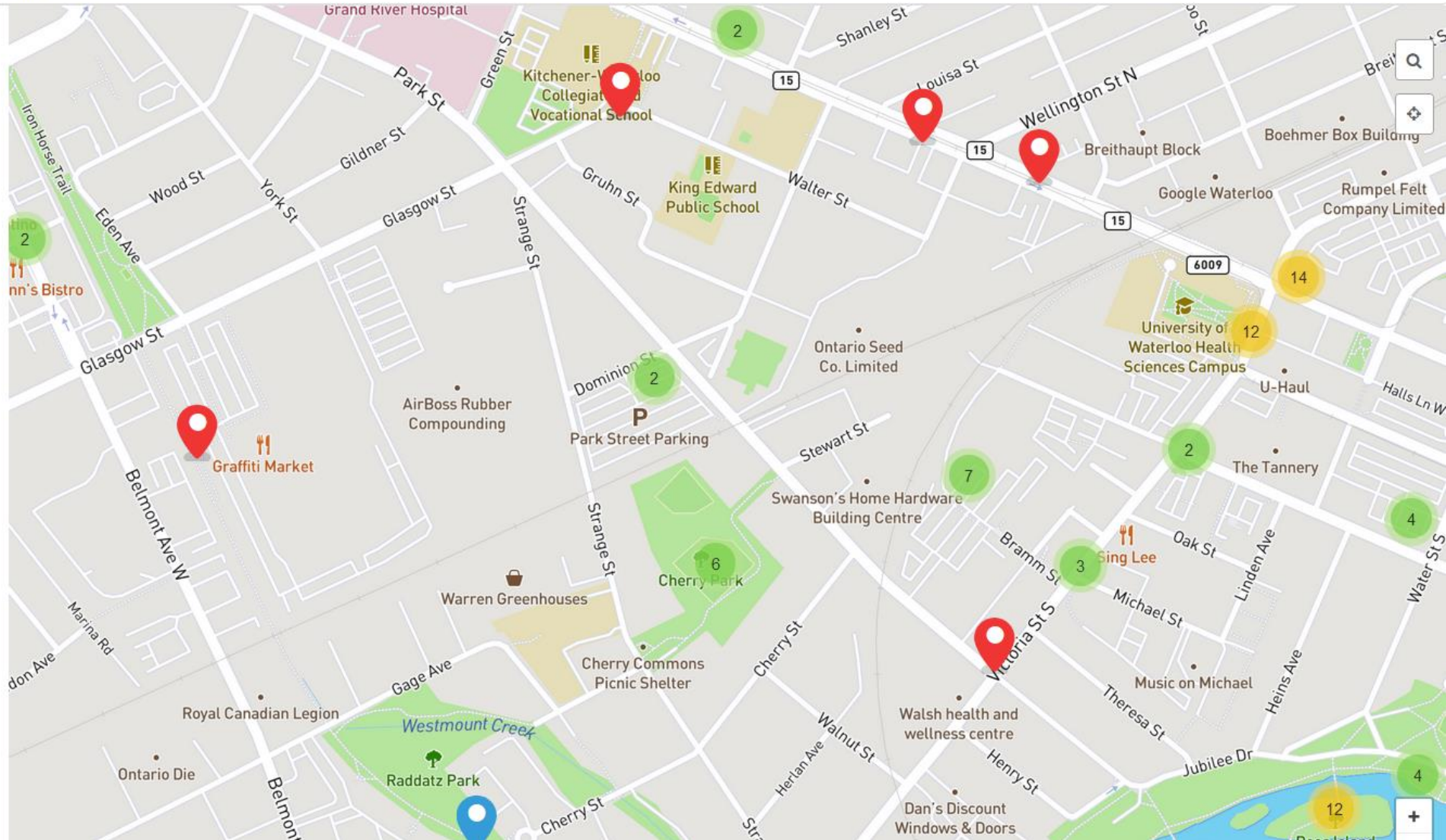

Livable Park and Victoria

- Monthly meetings
- Advocating for improved planning standards



Bramm Yards

- from Bramm Street to Park Street be set apart for community use and needs.
- green space in the area by the tracks to serve new residents.
- multiuse building that would meet our needs for recreational and community meeting spaces
- publicly owned or not- for-profit housing.

